



EZ-STARTER
Single Action–External Mix–Siphon Feed
Instruction Manual & Replacment Parts



OPERATING INSTRUCTIONS:

Approximate Working Pressures:

- 20 lbs. or Less: Stipple and granulated effects, pressure will vary with viscosity of fluid.
- 20 to 30 lbs.: Medium consistency water colors, inks & dyes.
- 30 lbs. or More: Heavy fluids, acrylics, reduced lacquers, varnishes, paints or ceramic glaze.

1. Attach hose to air supply and allow air to blow a few seconds. Shut off before attaching to Airbrush. This procedure will remove dirt from airline and hose.

Caution: Hold firmly and point away from face.

2. Attach hose coupling to the airbrush.
3. Attach Color Cup or Bottle to #6 Needle by exerting a firm twisting motion to fit tapered tube securely into tapered Needle inlet.
4. Fill Bottle 1/2 to 3/4 full. Use eyedropper or brush for adding small amounts of color to metal color cup. Vent hole must be kept open.
5. To Spray, hold Airbrush like a pencil comfortably between thumb and forefinger using middle finger as a guide and support. Like writing, hold forefinger easily on Button and Press to open air valve.
6. Regulate volume of color and size of spray by rotating #5 Tip clockwise to increase and counter clockwise to decrease flow of color.

CARE AND CLEANING:

1. Pour any remaining color back into its original container.
2. Wipe Bottle clean, using cloth moistened with proper solvent.
3. Hold Airbrush at a downward angle and put a few drops of solvent through #6 Needle, or fill bottle with Paint Cleaner to spray. To flush out the remaining color in the H Color Adjusting Part Assembly, apply pressure to the Button.

HOW TO OPEN CLOGGED FLUID PASSAGES:

1. Agitate color in Bottle Assembly by placing finger momentarily over #1 Aircap while air is passing through the Airbrush. This will blow color back into bottle thus opening clogged fluid passages.
2. Should Tip or Needle become clogged, pull #8 Clip, unscrew Tip from Needle, gently pull back through support and remove Tip.
3. Clean Parts carefully, using nothing harder than a wooden toothpick & your paint cleaner.
4. To reassemble, reverse this procedure.
5. If the needle and tip are completely clogged, Remove #7 "O"Ring (first) then soak in a closed bottle of proper solvent until clean.

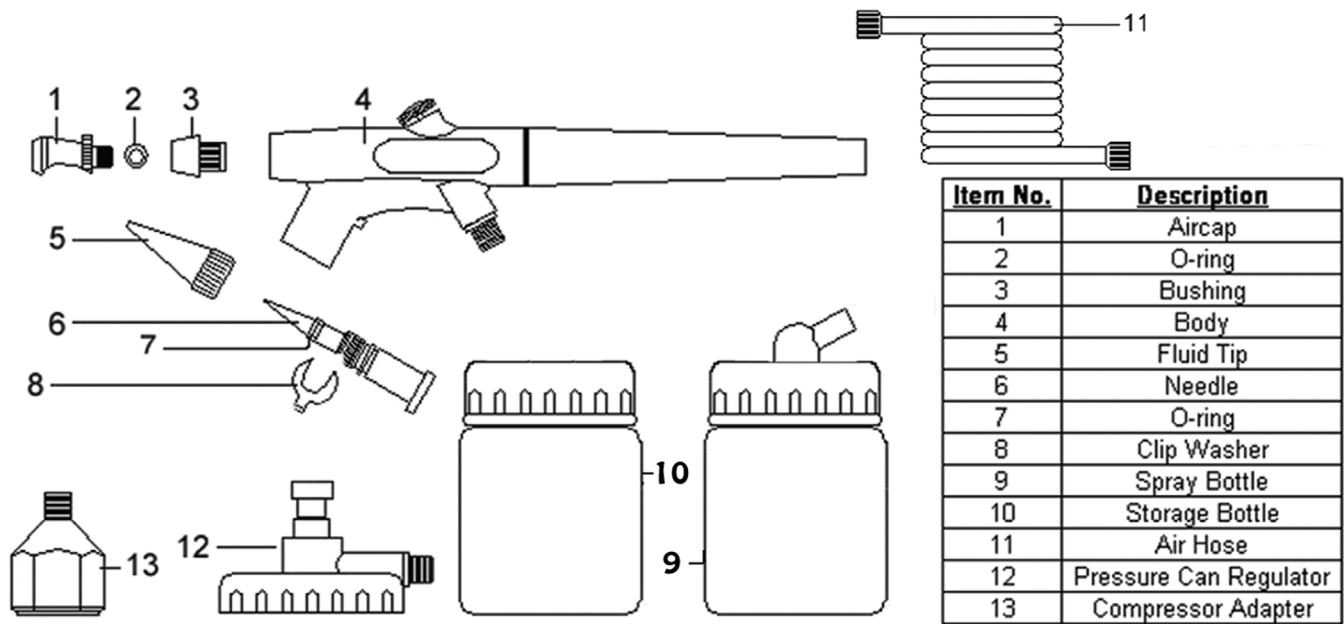

EZ-STARTER AIRBRUSH MODEL REPLACEMENT PARTS

Part No. Description

- 1. Aircap
- 2. O - Ring
- 3. Bushing
- 4. Body
- 5. Fluid Tip
- 6. Needle
- 7. O -Ring
- 8. Clip Washer
- 9. Spray bottle
- 10. Storage Bottle
- 11. Air Hose
- 12. Pressure Can Regulator
- 13. Compressor Adapter



The BA bottle assemblies are a new cover configuration and all use plastic bottle. The 2P and 4P are narrow neck and work with most airbrush paint bottles like Createx and Paasche

WARNING: Spray materials may be harmful if inhaled or allowed to come into contact with the skin or eyes. Consult the product label and Material Safety Data Sheet supplied for the spray material. Follow all safety precautions.
CAUTION: Well Ventilated Area Required to remove fumes, dust or overspray. **Maximum Air Pressure 50 P.S.I.**